

ADDENDUM NO. 02

ISSUE DATE: **October 28, 2021**

PROJECT: **Window and Door Replacement at Cary High School**
Wake County Public School System
WCPSS Project Number: 862-0710/368
Atlas Engineering Job No. J2443

FROM: **Mike Riccitiello, PE PMP - Atlas Engineering, Inc.**

TO (via email): Ben Cannon - WCPSS
Pre-Bid Meeting Attendees and Additional Designated Representatives

This addendum forms a part of the Contract Documents titled “Window Replacement at Cary High School” dated September 30, 2021. **Acknowledge receipt of this Addendum in the space provided on the Form of Proposal.** Failure to do so may subject the Bidder to disqualification.

This addendum consists of 1 page with 1 page of attachments, for a total of 2 pages.

PROJECT DRAWINGS

The attached E100 CARD READER RENOVATIONS (dated 28 October 2021) replaces the original E100 found in the drawing package. This new E100 corrects several inconsistencies between the electrical layout and architectural layout and clarifies the location of several card readers and associated equipment. No other changes were made to this revised E100 sheet.

END OF ADDENDUM

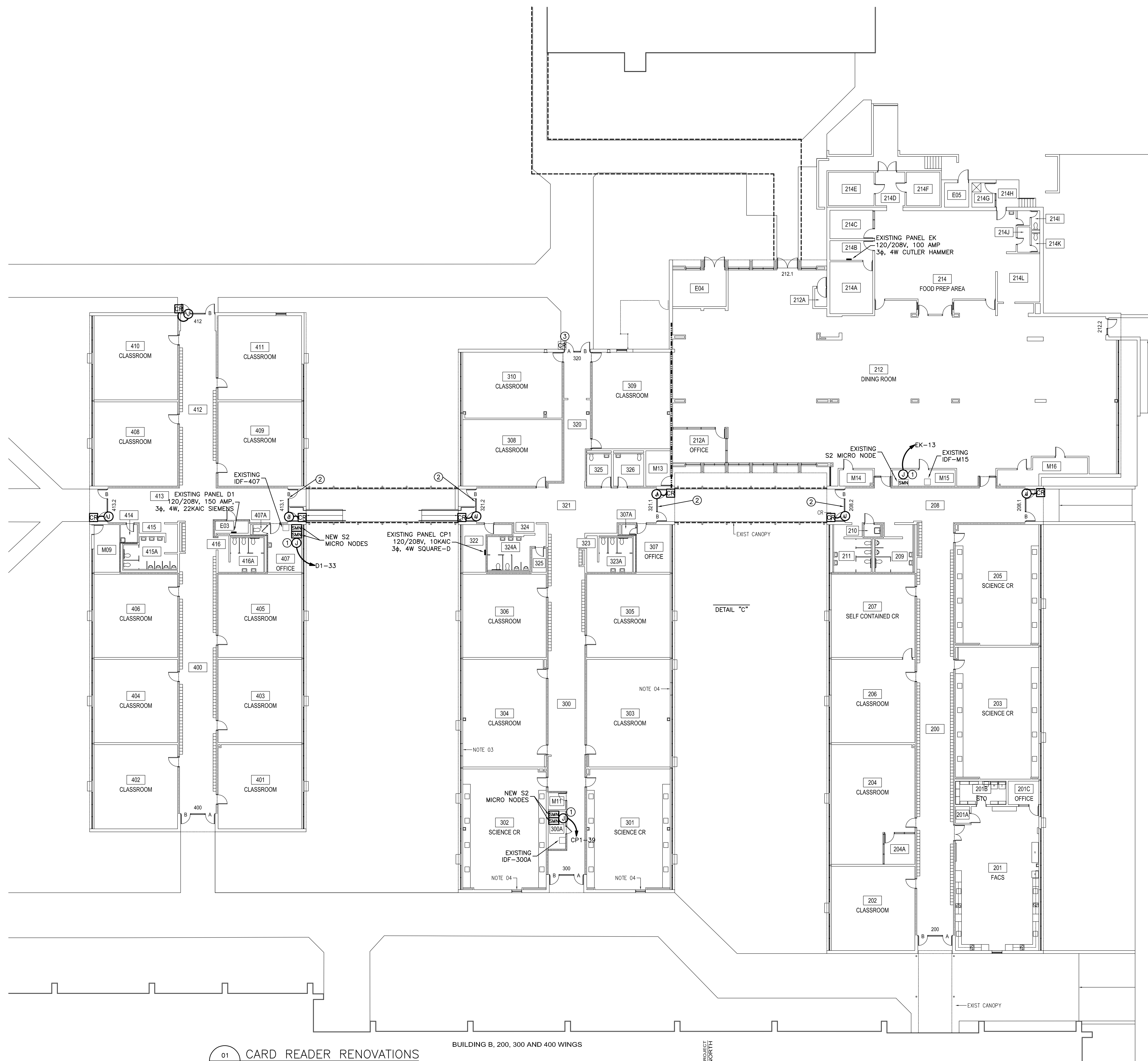

GENERAL NOTES:

- A. CONTRACTOR SHALL BE RESPONSIBLE FOR ANY DAMAGE THAT MAY OCCUR DURING CONSTRUCTION.
- B. COORDINATE ANY CONDUIT SLEEVES REQUIRED FOR ROUTING CABLING. ALL CONDUIT SLEEVES SHALL BE SEALED AFTER CABLING IS INSTALLED.
- C. CONTRACTOR SHALL VISIT SITE PRIOR TO BID.

KEYNOTES:

- 1. PROVIDE 120VAC POWER AT IDF ROOM FOR DOOR POWER SUPPLIES. PROVIDE NEW 20 AMP/1 POLE BREAKER IN EXISTING PANEL INDICATED. MATCH AIC OF EXISTING BREAKERS.
- 2. CONTRACTOR SHALL PROTECT EXISTING ELECTRICAL RACEWAYS AND CABLING PENETRATING TRANSOM ABOVE DOOR THROUGHOUT CONSTRUCTION. COORDINATE WITH WCPSS TO IDENTIFY ANY ABANDONED OR UNUSED CABLING OR RACEWAYS WHICH CAN BE REMOVED. ALL ACTIVE COMPONENTS MUST BE PROPERLY SUPPORTED THROUGHOUT CONSTRUCTION. SEAL PENETRATIONS THROUGH NEW BARRIERS SO THAT THEY ARE WATER TIGHT AROUND EXISTING RACEWAYS AND CABLES. PROVIDE NEW SLEEVES FOR CABLING AS NEEDED TO PROTECT CABLING JACKETS.
- 3. EXISTING CARD READER, ACCESS CONTROL CABLING AND ASSOCIATED RACEWAYS TO BE REPLACED WITH NEW TO ACCOMMODATE NEW DOOR.

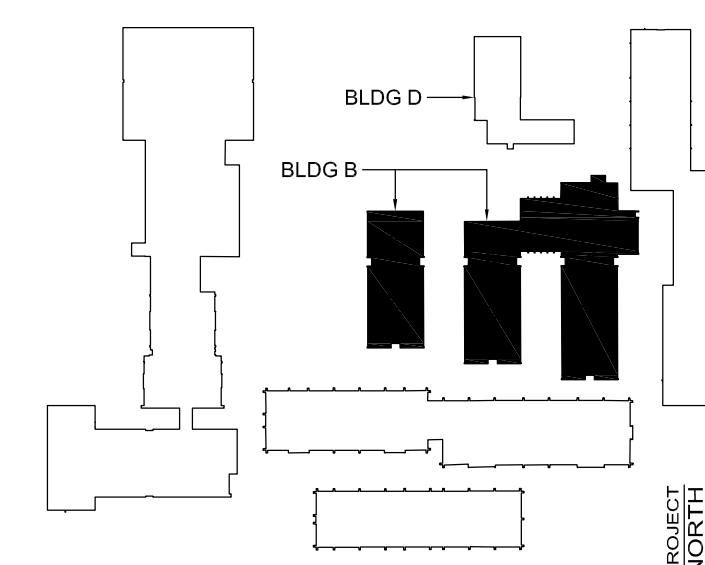

CAMPUS KEY PLAN
NO SCALE

01 CARD READER RENOVATIONS
E100 1/16" = 1'-0"

BUILDING B, 200, 300 AND 400 WINGS



WINDOW REPLACEMENT

CARY
HIGH SCHOOL

638 WALNUT STREET
CARY, NC 27511

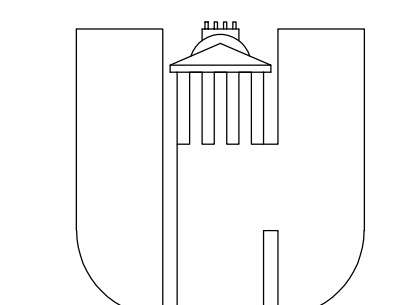

WAKE COUNTY
PUBLIC SCHOOL SYSTEM

RALEIGH, NORTH CAROLINA

CARD READER
RENOVATIONS

DATE: 9/30/2021
JOB NO: J2443
DRAWN BY: JPT
CHECKED BY: KKF
APPROVED:

E100

NO: