



Town of Hillsborough

Addendum #1 for the Lawndale Basin Sewer Rehabilitation and Replacement Project  
Questions and Responses from the Pre-Bid Meeting: 7-11-2023

1. Clarification on the hydrant meter: A hydrant meter is to be rented for water consumption during the project. Contractor to put a deposit on the meter and pay the rental fee. No charge for water usage. Water must be obtained through the meter, direct connections to hydrants are not permitted.
2. Clarification on CIPP curing process for winched insertion: Hot water curing or steam curing may be used for the winched insertion method.
3. Clarification on a dump site, for sewage/solids management: Contractor to coordinate with the Town of Hillsborough's WWTP operators for dump site location.
4. Clarification on private property access under the Alternate Bids: The Town will coordinate Right-of-Entry agreements with private property owners.
5. Clarification on the method of installation for lateral connections to the mainline: Romac saddle allowed for installation of laterals to the mainline. An in-line wye is not required.
6. Is CCTV available?: Yes, the Town will upload the CCTV files to the One-Drive folder
7. Will a recording of the pre-bid be made available?: Yes, the pre-bid meeting recording link is available [here](#).
8. Clarification on lined manholes: Contractor to repair any manholes damaged during the project. If a lined manhole is damaged, it must be repaired per lining manufacturer's recommendations (contact TPT Coating). The manholes below are among those that have lining, also see the attached exhibit.
  - a. SMH-1219
  - b. SMH-1218
  - c. SMH-1213
  - d. SMH-2794
  - e. SMH-1211
  - f. SMH-1214
  - g. SMH-1216



- h. SMH-1206
  - i. SMH-1205
  - j. SMH-1222
  - k. SMH-1223
  - l. SMH-1225
  - m. SMH-1230
  - n. SMH-1229
  - o. SMH-1228
9. Clarification on warranty period for private property work under the Alternate Bid: The Contractor's plumber must warranty the work on private property directly with the homeowner for one (1) year, this warranty will be referenced in the Right of Entry document.
10. Clarification of locations under Alternate B: Call out added to Sheet C1.3 for laterals to abandon in place.
11. Additional note added to Alternate Bid Notes: Lateral replacements will require some field verification by the contractor. The locations of some laterals will likely be different than drawn.

THIS AND ANY OTHER ELECTRONIC MEDIA CONSTITUTE AN INSTRUMENT OF SERVICE PREPARED BY MERRICK & COMPANY FOR A SPECIFIC PROJECT. IT IS NOT INTENDED OR REPRESENTED TO BE SUITABLE FOR REUSE IN WHOLE OR IN PART ON EXTENSIONS OF THE PROJECT OR ON ANY OTHER PROJECT. REUSE OR MODIFICATION OF ANY INFORMATION NOT A PART OF THE INSTRUMENT OF SERVICE WITHOUT THE EXPRESS WRITTEN CONSENT OF MERRICK & COMPANY IS PROHIBITED. THE USER ASSUMES ALL LIABILITY FOR ANY DAMAGE TO PERSONS OR PROPERTY CAUSED BY THE USE OF THIS INFORMATION.

File Location: Q:\CH\PA\Projects\0403-00-Hillsborough Sewer Model\Design\CDs\Civil\Drawings\Addendum\Sp-Lawndale\CDs.dwg Plot Date: 7/14/2023 2:25 PM Last Saved By: RHUTCHINSON

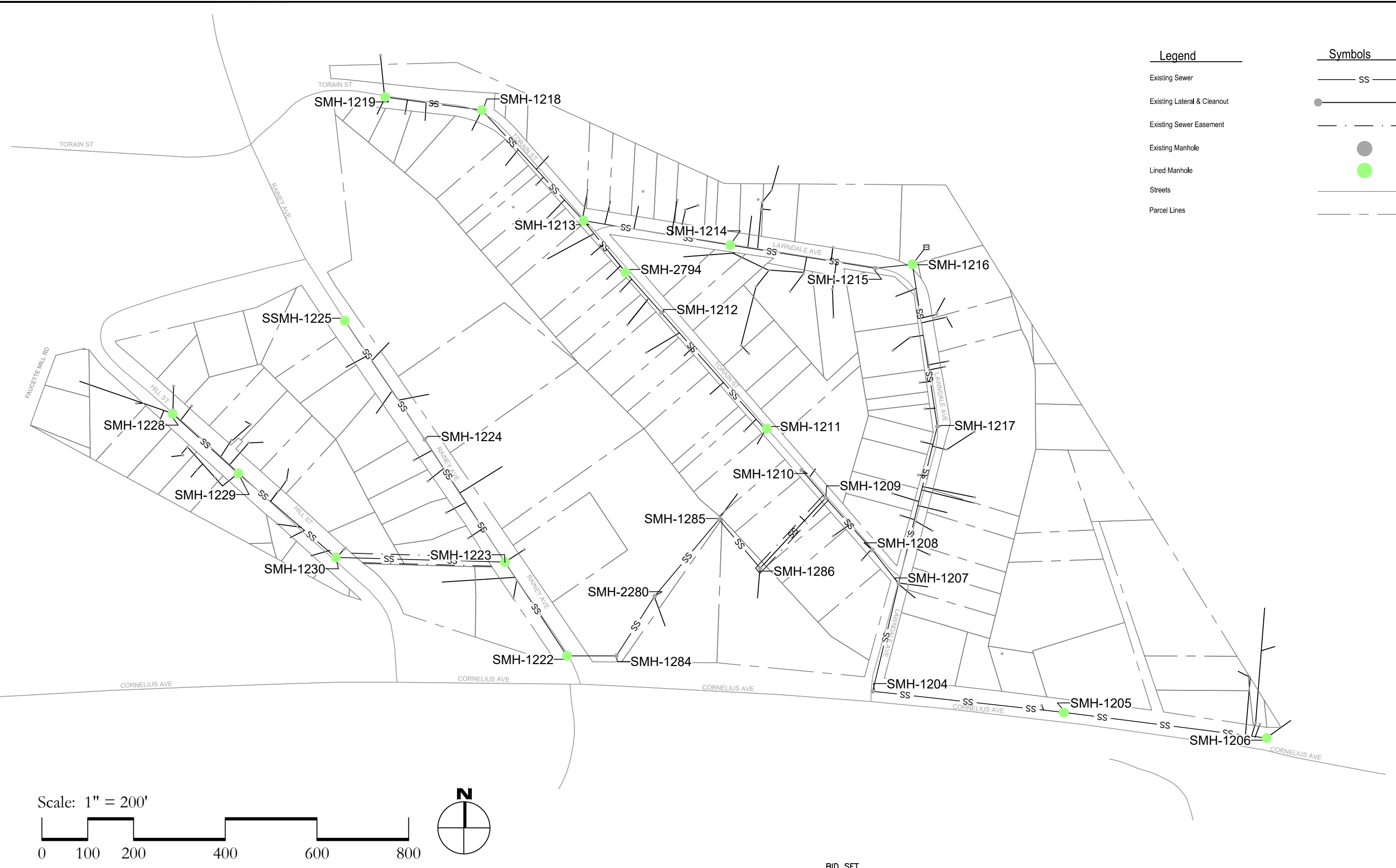

Legend	Symbols
Existing Sewer	SS
Existing Lateral & Cleanout	●
Existing Sewer Easement	- - -
Existing Manhole	●
Lined Manhole	●
Streets	—
Parcel Lines	- - -

Scale: 1" = 200'

REV	REVISION DESCRIPTION	DATE	CHND	CHKD	APPR

CALL BEFORE YOU DIG

Know what's below.  
Call before you dig.

TOWN APPROVAL

ACCEPTED BY: \_\_\_\_\_ DATE \_\_\_\_\_

TOWN ENGINEER (or Designee)

Engineering | Architecture | Design-Build | Surveying | Planning | Geospatial Solutions

5970 GREENWOOD PLAZA BLVD. GREENWOOD VILLAGE, CO. 80111  
303-751-0741  
www.merrick.com

BID SET

FE STAMP

FOR AND ON BEHALF OF MERRICK & COMPANY

TITLE

LAWDALE BASIN SEWER  
REHABILITATION AND REPLACEMENT  
LINED MANHOLE MAP

JOB NUMBER  
65420403

DATE  
7/13/2023

SHEET  
C1.0

of