

SEAL

ADDENDUM #2

SCALE: AS SHOWN

BID DOCUMENTS
NOT FOR CONSTRUCTION

No.	DATE	BY	DESCRIPTION
0	1/22/24	CPR	BID DOCS

REVISIONS

DRAWN BY TGL

APPROVED BY CPR

CHECKED BY RBR

DATE JANUARY 22, 2024

TITLE

CIVIL
DETAILS

PROJECT NO. 50167133

C501

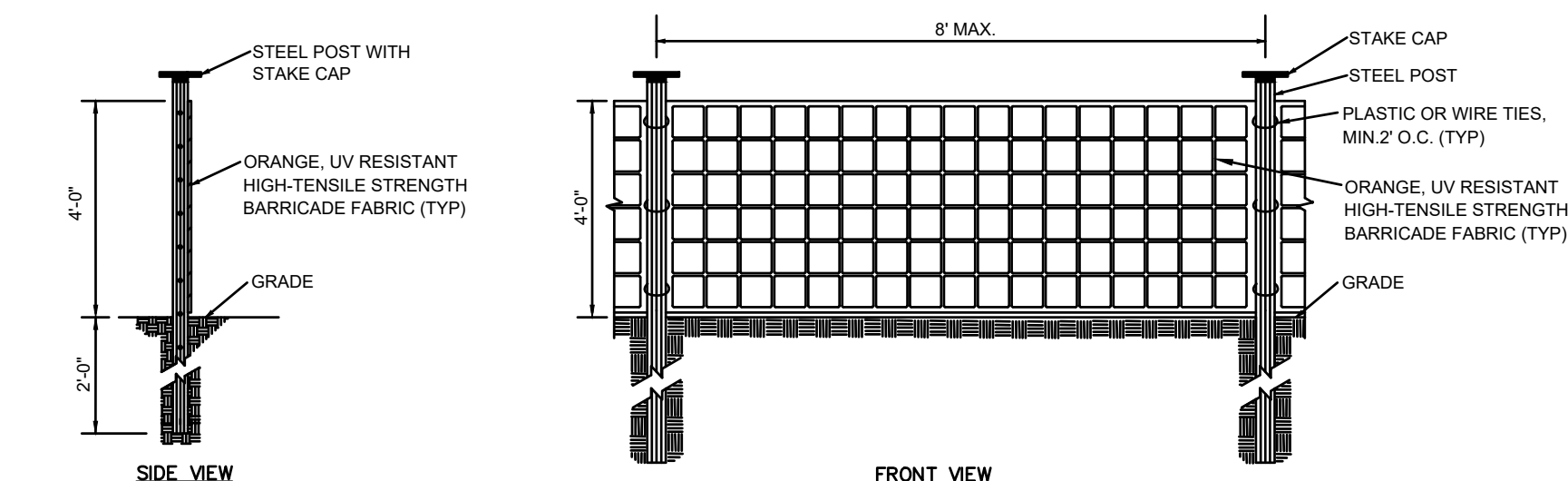

INSTALLATION SPECIFICATIONS

MATERIALS:

- USE ORANGE, UV RESISTANT, HIGH TENSILE STRENGTH BARRICADE FABRIC WHICH IS RESISTANT TO RUST AND CORROSION.
- ENSURE THAT THE POSTS ARE STEEL AND ADEQUATE TO SUPPORT THE FABRIC. THE POSTS MUST HAVE PROJECTIONS TO FACILITATE FASTENING THE FABRIC.
- WIRE OR PLASTIC ZIP TIES SHOULD HAVE A ADEQUATE TENSILE STRENGTH TO SUPPORT THE FABRIC.

CONSTRUCTION:

- DRIVE STEEL POST 24" INTO THE GROUND (MAX. 8' BETWEEN POSTS). DO NOT DRIVE STAKES THROUGH TREE ROOTS OR CUT TREE ROOTS INSIDE THE TREE DRIP LINE.
- SUPPORT FILTER FABRIC WITH WIRE MESH FASTENED SECURELY TO THE UPSLOPE SIDE OF THE POSTS. EXTEND THE WIRE MESH SUPPORT TO THE BOTTOM OF THE 8' TRENCH.
- CONSTRUCT THE FABRIC FROM A CONTINUOUS ROLL, CUT TO LENGTH OF THE BARRIER TO AVOID JOINTS. WHEN JOINTS ARE NECESSARY, SECURELY FASTEN THE FABRIC ONLY AT A SUPPORT POST WITH A MINIMUM OF 4 FEET OF OVERLAP TO THE NEXT POST.
- PLACE BARRIERS TO PREVENT THE APPROACH OF EQUIPMENT WITHIN THE CONSTRUCTION AREA.
- DO NOT ATTACH FABRIC TO TREES.
- DO NOT INSTALL FABRIC ACROSS STREAMS, DITCHES, WATERWAYS, OR OTHER AREAS OF CONCENTRATED FLOW.

MAINTENANCE:

- INSPECT SAFETY FENCE AT LEAST ONCE PER WEEK. REPAIR/RE-STAKE BARRIER AS NECESSARY DURING CONSTRUCTION. SHOULD THE FABRIC COLLAPSE, TEAR, DECOMPOSE OR BECOME INEFFECTIVE, REPLACE IT PROMPTLY TO ENSURE A SAFE WORKING AREA. BARRIER(S) MAY NEED TO BE ADJUSTED ACCORDINGLY DURING CONSTRUCTION TO PROVIDE DRAINAGE OF THE SURROUNDING AREA.
- MAINTAIN FENCING THROUGHOUT DURATION OF PROJECT AS NECESSARY. UPON COMPLETION OF CONSTRUCTION AND THE SITE IS APPROVED BY THE TOWN OF KNIGHTDALE AND/OR OWNER, REMOVE ALL FENCING AND ASSOCIATED MATERIALS.

4 TEMPORARY CONSTRUCTION FENCE DETAIL
C501 NOT TO SCALE

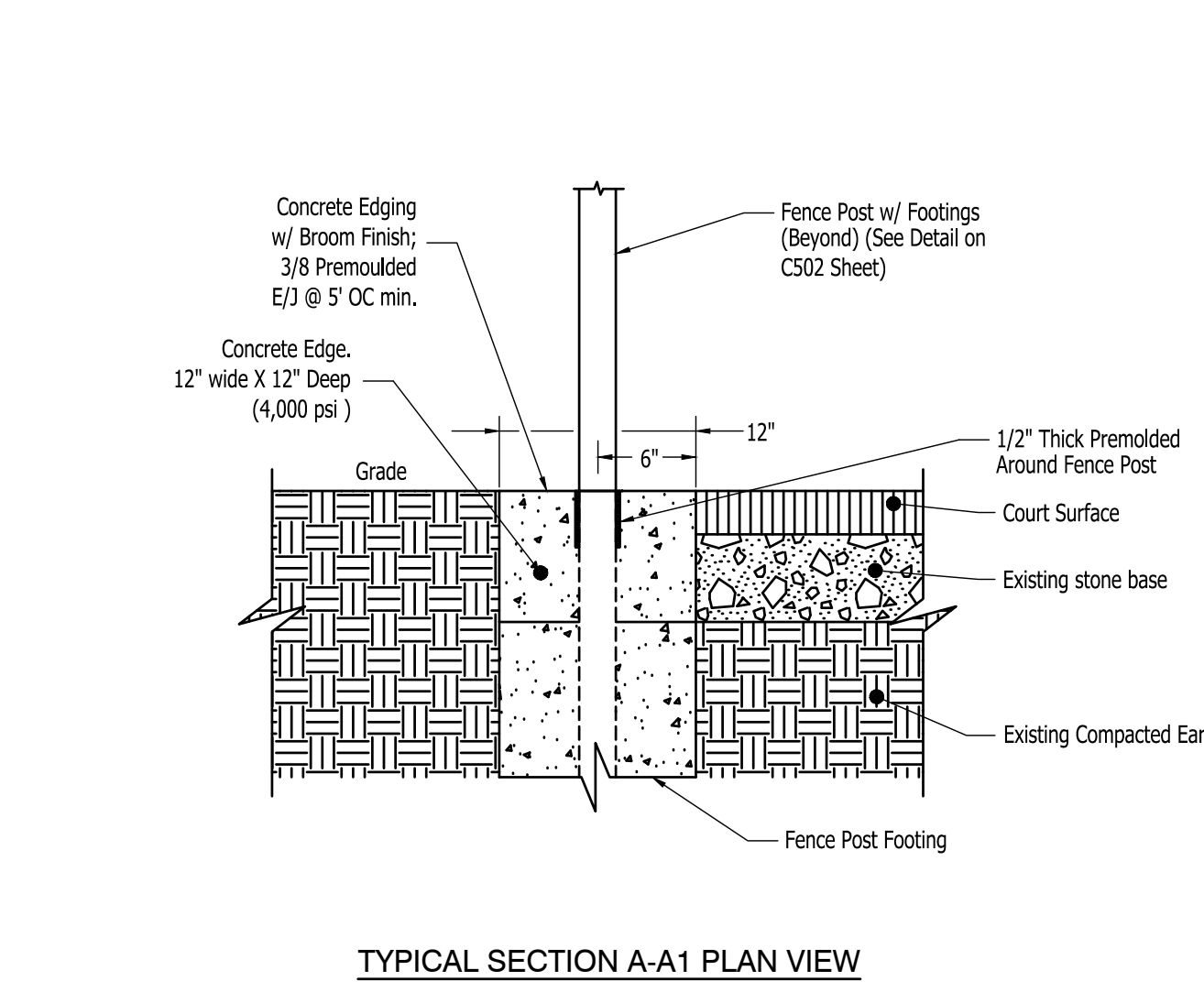
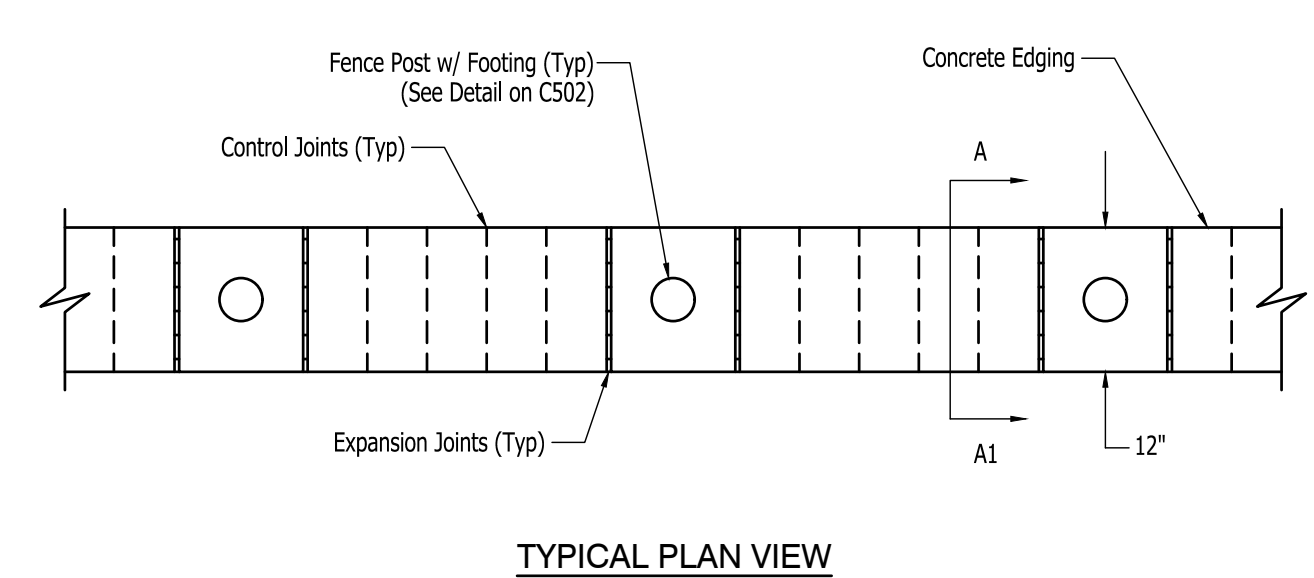

NOTES:

- CONTRACTOR SHALL COMPACT SUBGRADE TO A MINIMUM 95% MODIFIED PROCTOR MAXIMUM DRY DENSITY.

5 CONCRETE EDGE DETAILS
C501 NOT TO SCALE

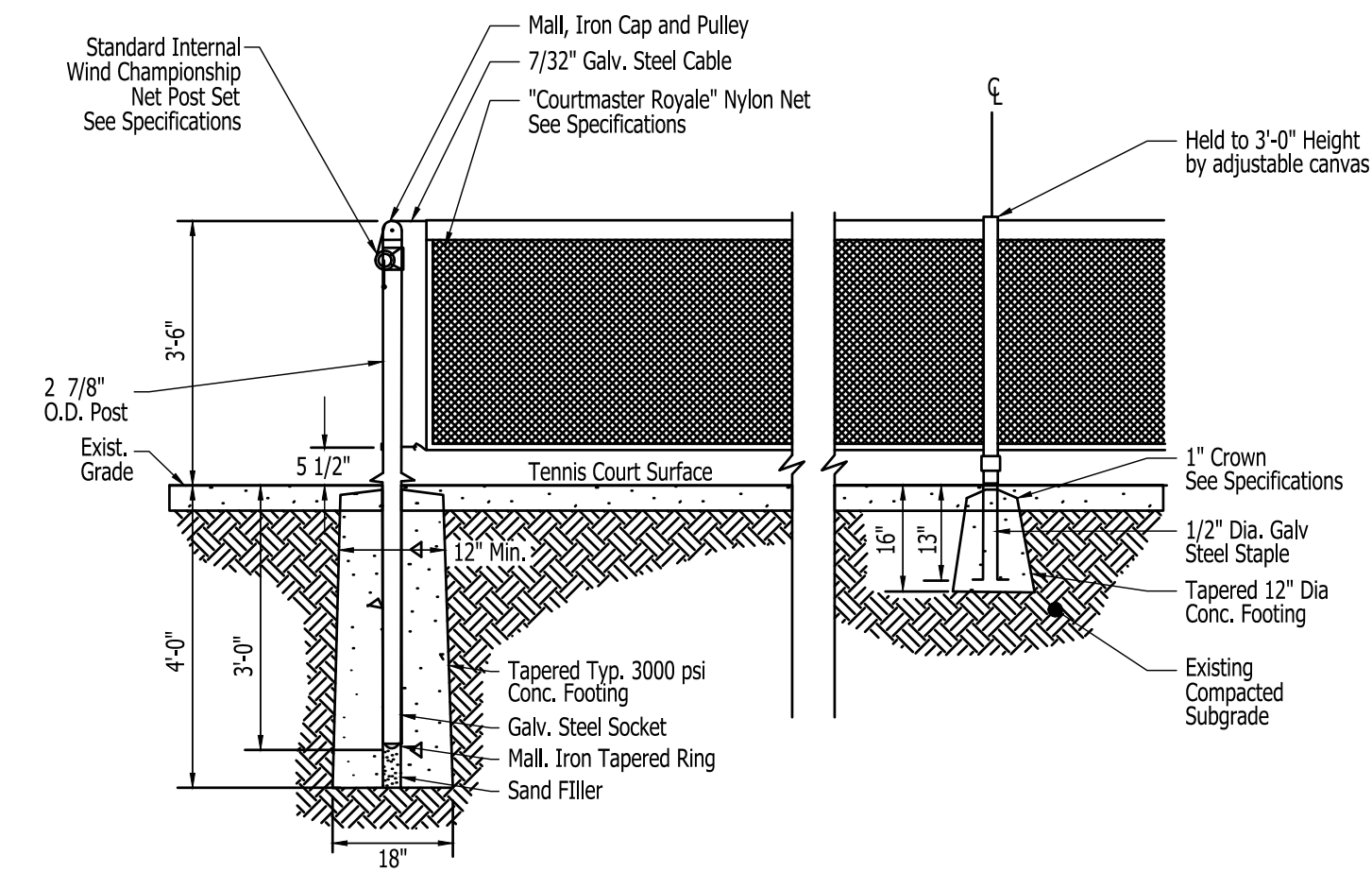

NOTES:

- ALL EQUIPMENT SHALL BE INSTALLED PER MANUFACTURER'S STANDARDS AND RECOMMENDATIONS.

3 TENNIS NET AND POST PLUS CENTER ANCHOR DETAIL
C501 NOT TO SCALE

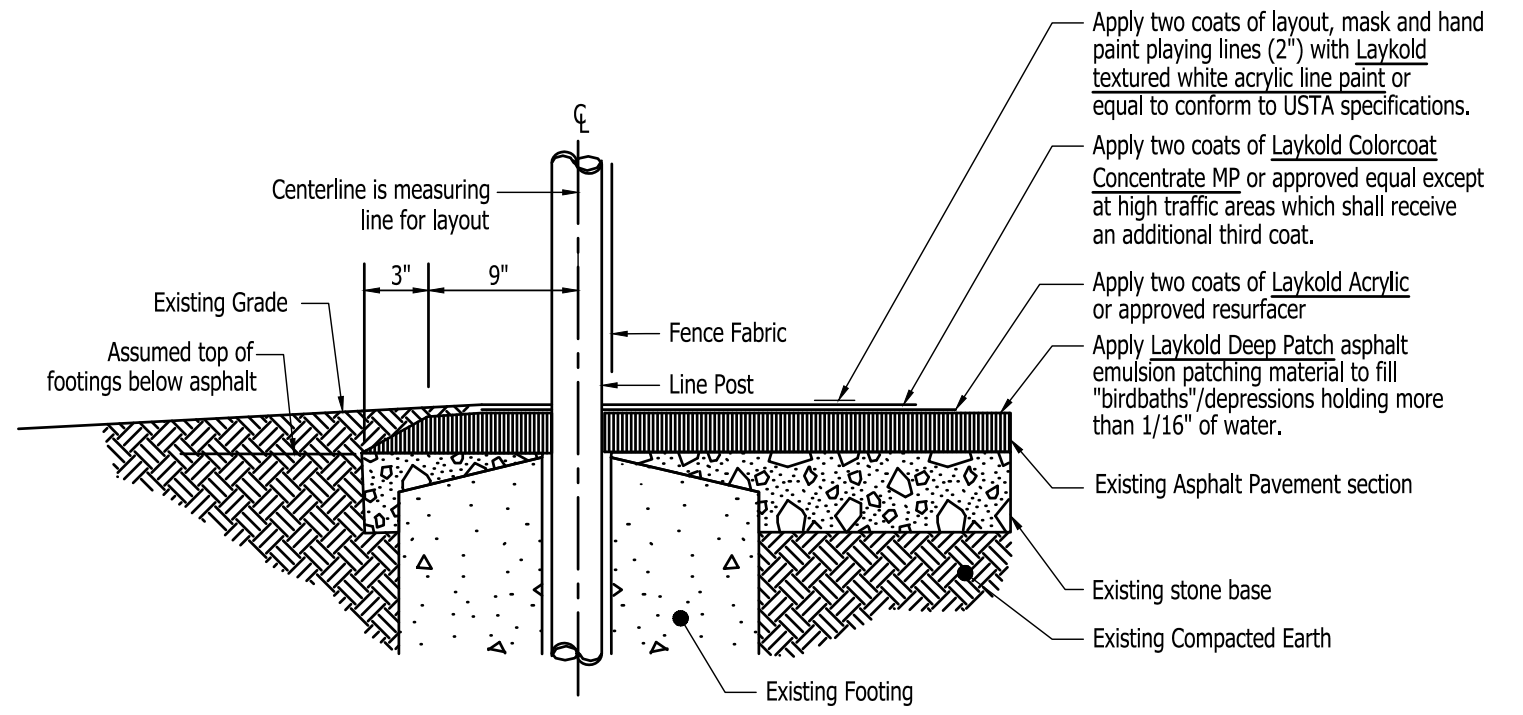

2 TENNIS COURT PAVING DETAIL
C501 NOT TO SCALE

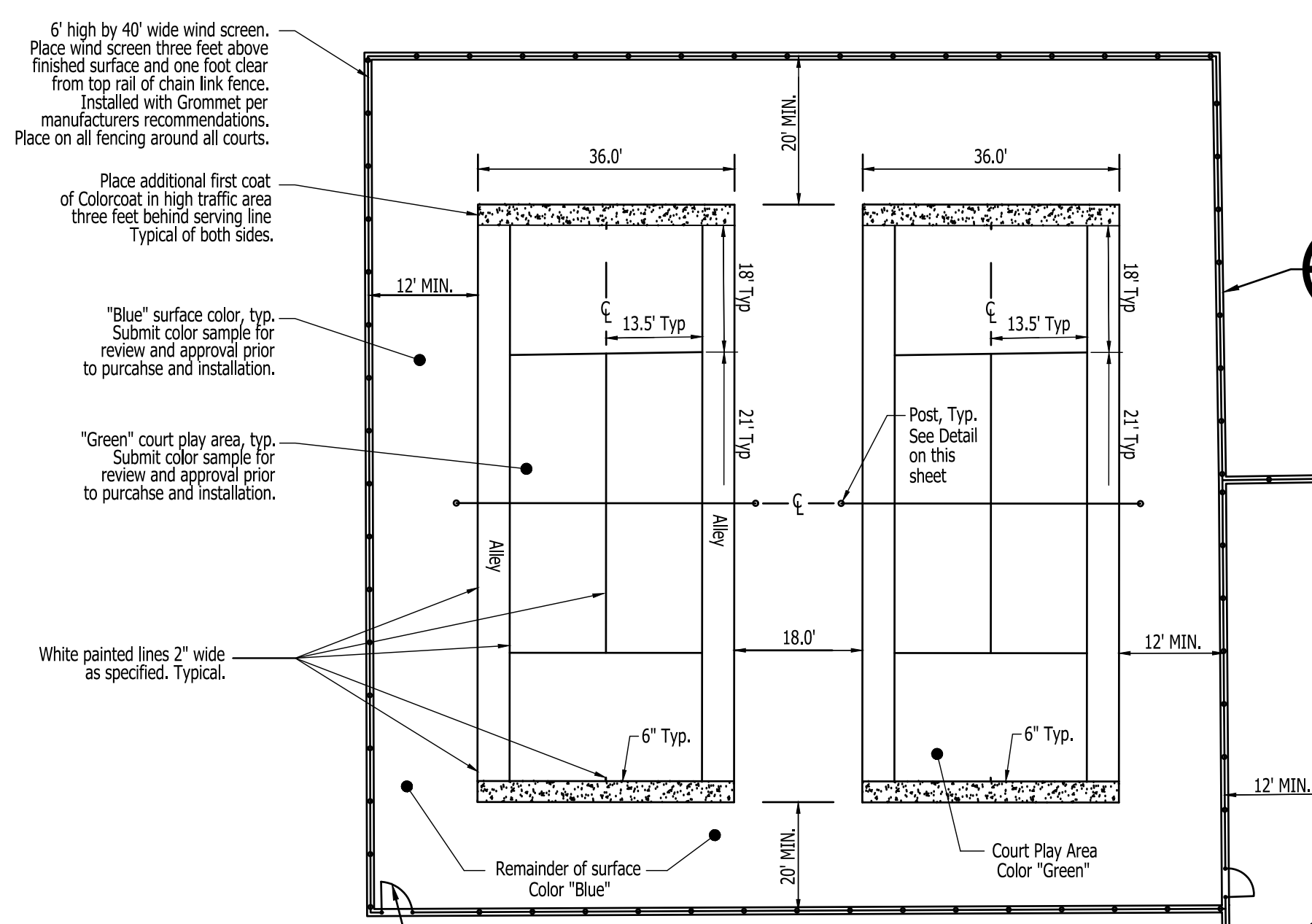

2 TENNIS COURT (SINGLE GATE) (TYP)
C502

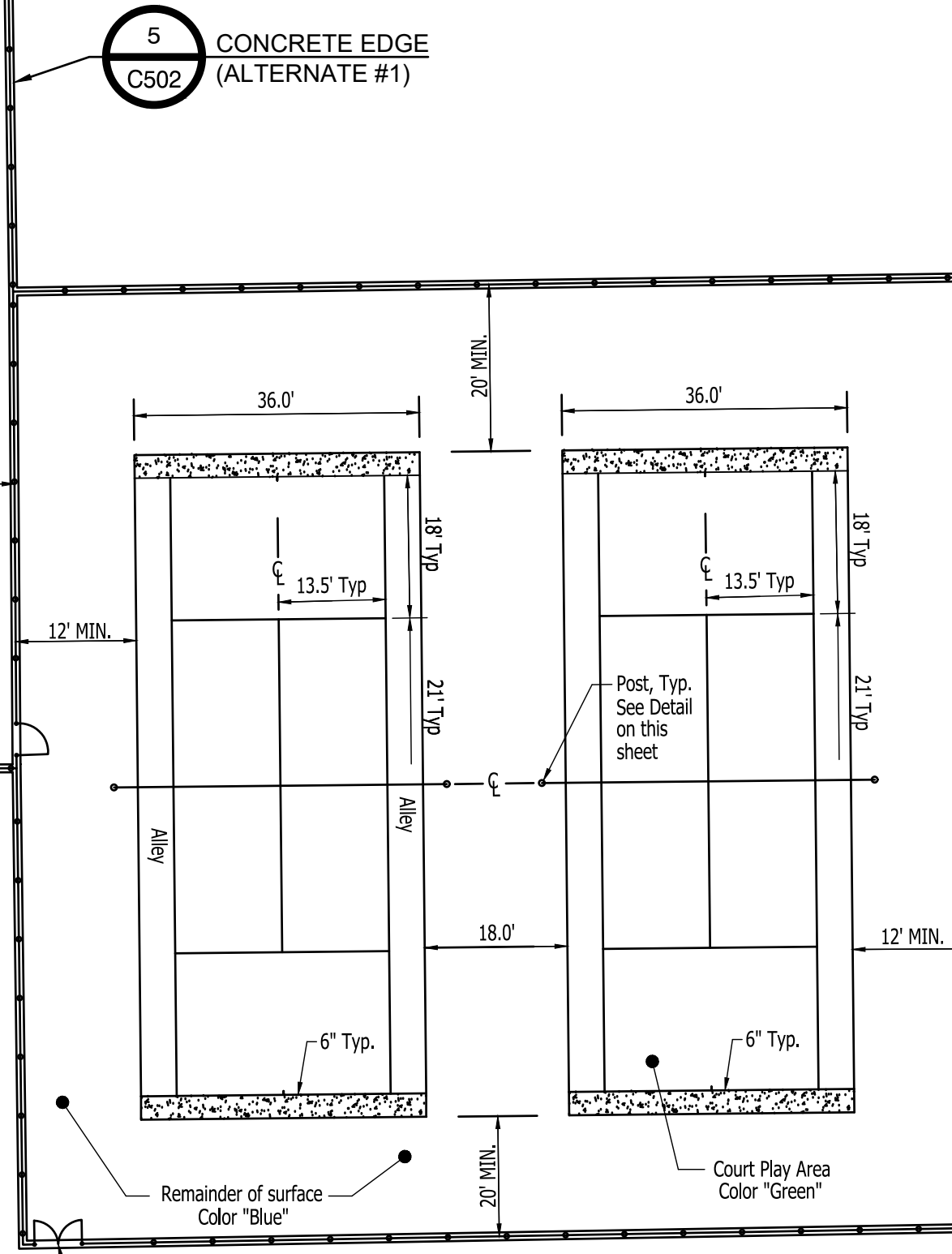

3 TENNIS COURT (DOUBLE GATE)
C502

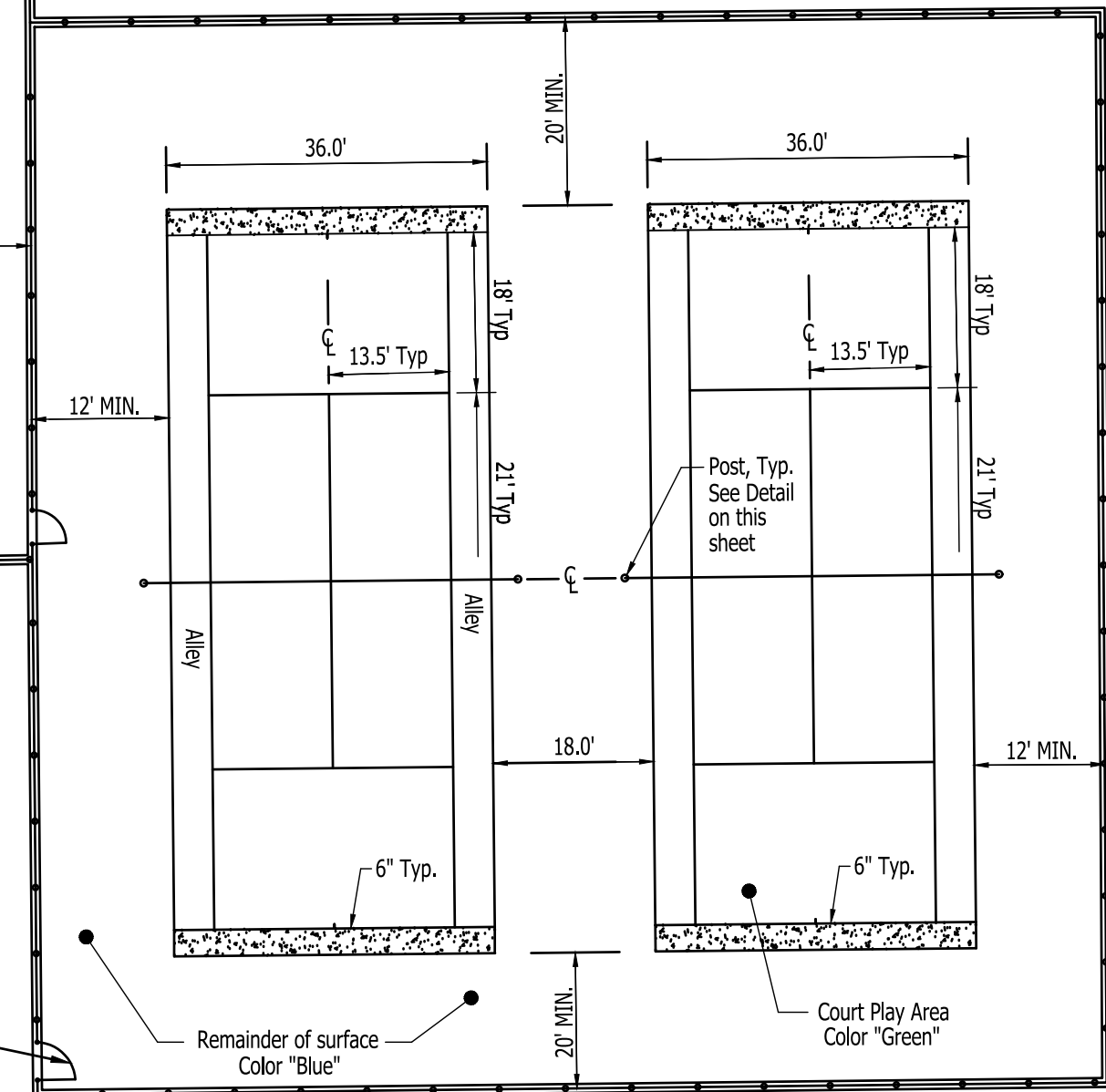

2 TENNIS COURT (SINGLE GATE) (TYP)
C502

NOTE: ALL DIMENSIONS ARE TO OUTSIDE OF LINES EXCEPT CENTERLINES.

1 TENNIS COURT LAYOUT
C501 NOT TO SCALE

E
D
C
B
A